

THE INFORMATION CONTAINED IN THIS DRAWING IS THE SOLE PROPERTY OF ANDERSON POWER PRODUCTS. ANY REPRODUCTION IN PART OR WHOLE WITHOUT THE WRITTEN PERMISSION OF ANDERSON POWER PRODUCTS IS PROHIBITED.

Copyright 2006

ANDERSON POWER PRODUCTS RESERVES THE RIGHT TO ALTER PRODUCT TYPES, THEIR TECHNICAL DATA, DIMENSION, STYLE AND ACCESSORIES WITHOUT PRIOR NOTIFICATION.

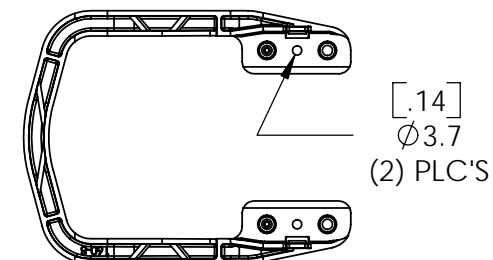
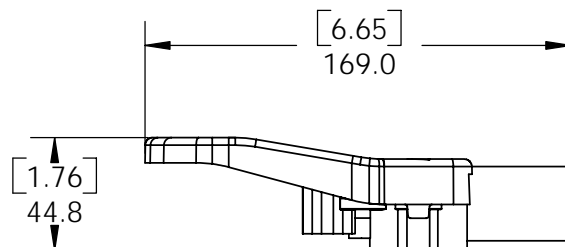
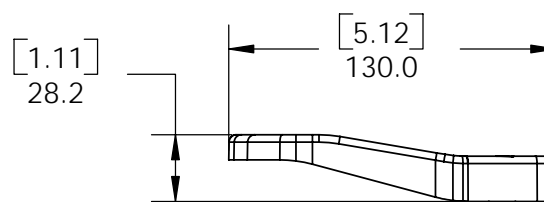
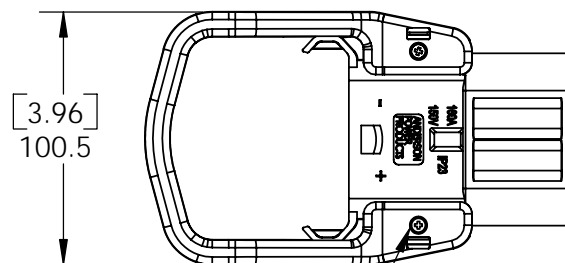
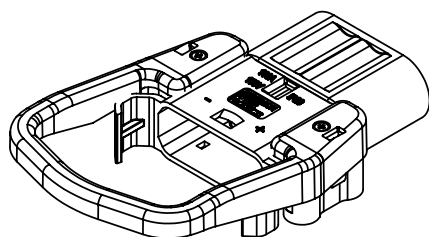

NOTES:

1. KIT INCLUDES HANDLE AND (2) SELF-TAPPING SCREWS
2. FOR USE WITH 160A & 320A CONNECTORS

PART NO.	DESCRIPTION	COLOR	MATERIAL
EP16-89	160/320 HANDLE KIT	GRAY	PBT-PC BLEND
E16-89	160/320 HANDLE KIT	GRAY	POLYPROPYLENE
16-89	160/320 HANDLE KIT	BLACK	NYLON

DIMENSIONS ARE IN:	MM[INCH]
UNLESS OTHERWISE STATED	
TOLERANCES:	
DECIMALS (INCH)	DECIMALS (MM) ANGLES
XX ±.02	X ±.5 ±2°
SURFACE FINISH:	
MACHINED	128 [3.2] ✓
MOLDED	64 [1.6] ✓
MATERIAL: SEE DATA SHEETS FOR MATERIAL SPECS	
FINISH: N/A	

APPROVALS	
DRAWN	AMS 01/20/06
CHECKED	DJD 01/20/06
MFG APP	CHB 01/19/06
QC APP	UFN 01/20/06
ENG APP	DAM 01/19/06

ANDERSON POWER PRODUCTS

SALES OUTLINE
LOW PROFILE HANDLE
FOR 160A & 320A CONNECTORS

SIZE: A/A4 DWG NO.: E160-8S1 REV.: 1

SCALE: NONE CADFILE: 02497 SHEET: 1 OF 1

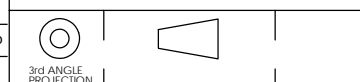

1	ECRN 13995 - INCORRECT P/N LISTED	AMS	04/24/06
REV.	DESCRIPTION OF CHANGES	APPROVED	DATE