

8

7

6

5

4

3

2

1

THE INFORMATION CONTAINED IN THIS DRAWING IS THE SOLE PROPERTY OF ANDERSON POWER PRODUCTS. ANY REPRODUCTION IN PART OR WHOLE WITHOUT THE WRITTEN PERMISSION OF ANDERSON POWER PRODUCTS IS PROHIBITED.

Copyright 2006

ANDERSON POWER PRODUCTS RESERVES THE RIGHT TO ALTER PRODUCT TYPES, THEIR TECHNICAL DATA, DIMENSION, STYLE AND ACCESSORIES WITHOUT PRIOR NOTIFICATION.

E

E

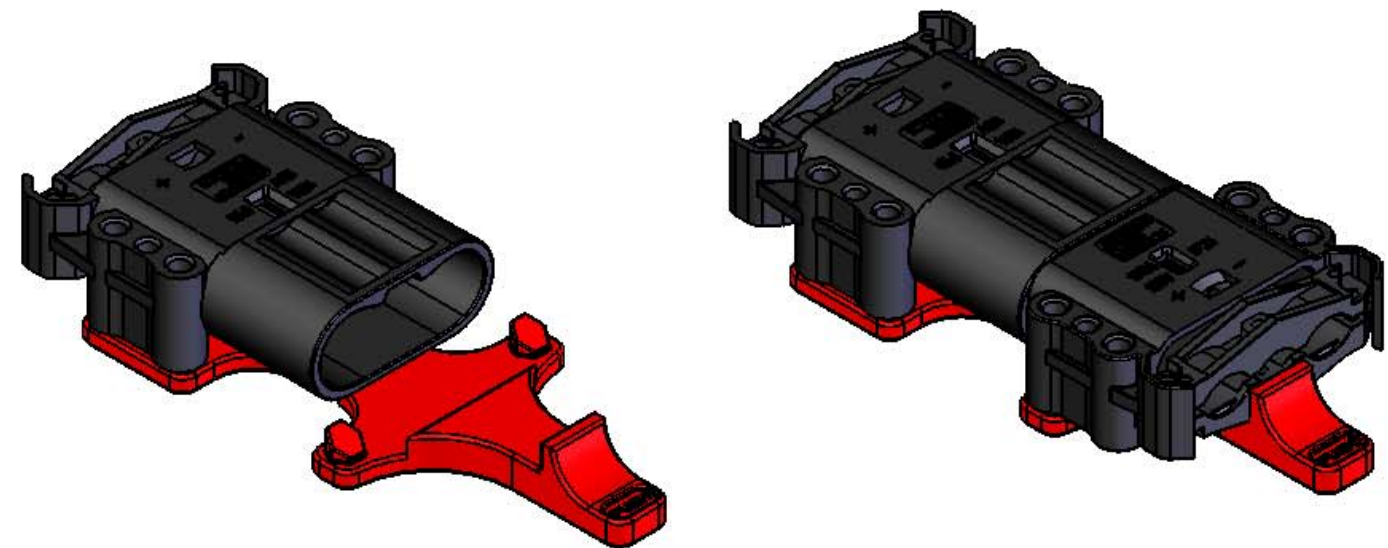
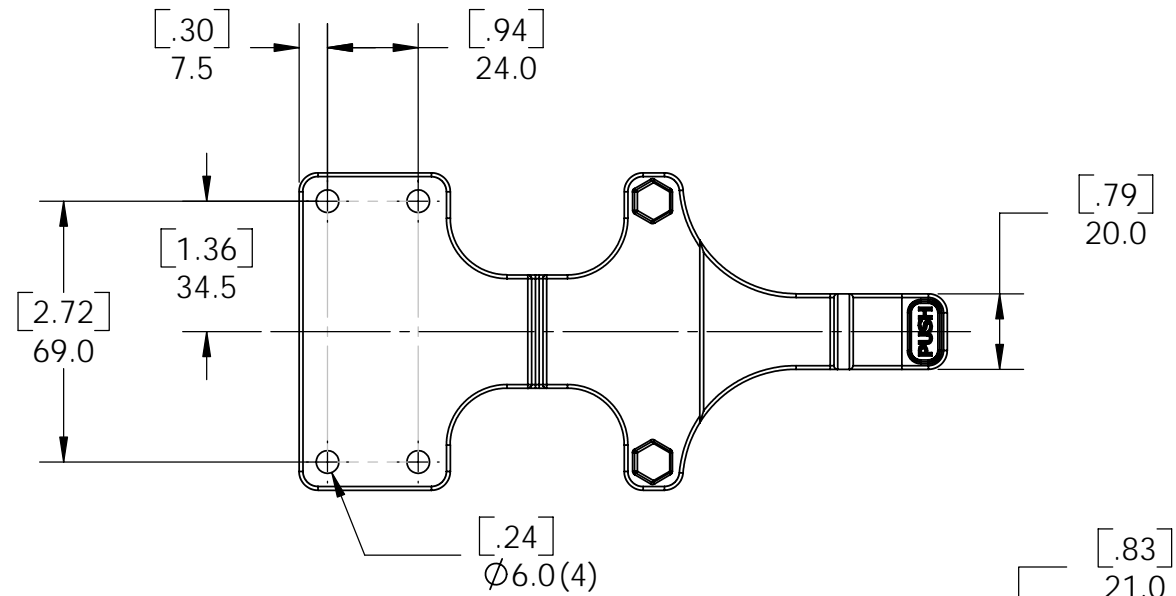

D

D

C

C

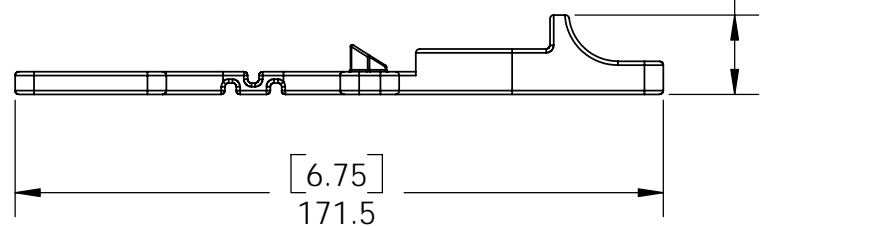

- NOTES:
 1. CONNECTORS SOLD SEPARATELY
 2. FOR BOTTOM-MOUNTING APPLICATIONS ONLY

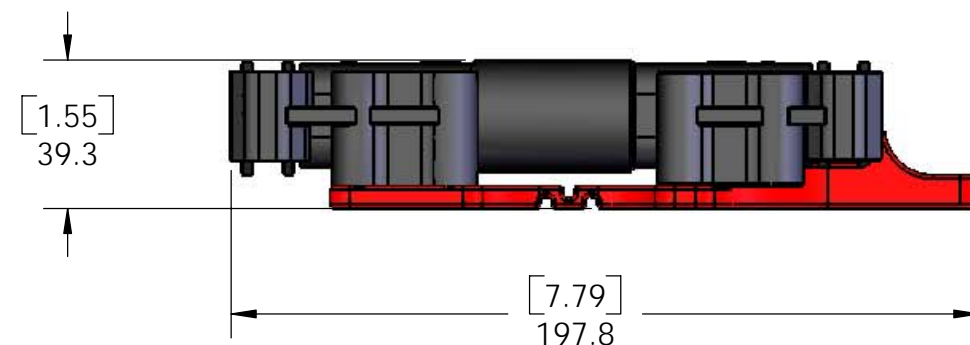

B

B

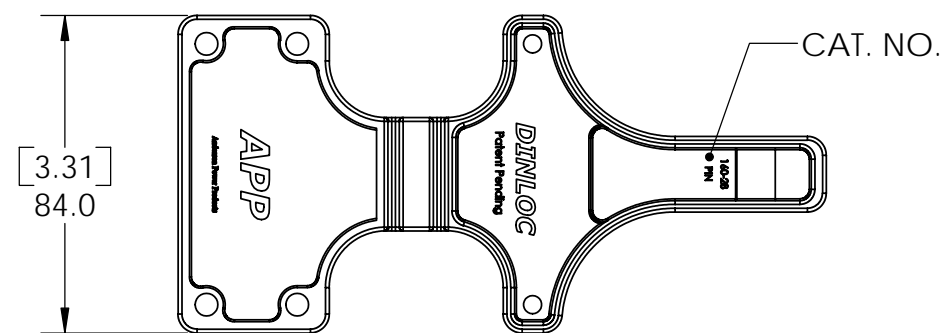

A

A

DINLOC LATCHING SYSTEM		
CAT. NO.	DESCRIPTION	MOUNTS TO:
160-28	160A DINLOC	PIN HSG (160-1, E160-1, EN160-1 & EP160-1)
160-29	160A DINLOC	SOCKET HSG (160-2, E160-2, EN160-2 & EP160-2)
320-26	320A DINLOC	PIN HSG (320-1, E320-1, EN320-1 & EP320-1)
320-27	320A DINLOC	SOCKET HSG (320-2, E320-2, EN320-2 & EP320-2)

DIMENSIONS ARE IN:	INCH[MM]	MM[INCH]	APPROVALS		 ANDERSON POWER PRODUCTS
UNLESS OTHERWISE STATED			DRAWN	AMP 12-8-04	
TOLERANCES:			CHECKED	DJD 12-16-04	
DECIMALS (INCH) .XX ± .02			MFG APP	DAM 12-16-04	
SURFACE FINISH:			QC APP	JAR 12-16-04	DINLOC LOCKING PLATE FOR 160A/320A DIN CONNECTORS
MACHINED 128 [3.2]			ENG APP	CHB 12-16-04	
MOLDED 64 [1.6]					SIZE B/A3
MATERIAL: POLYPROPYLENE GF					DWG NO. E160/320-37S1
FINISH: N/A					REV. 2
3rd ANGLE PROJECTION			-CAD GENERATED DRAWING- DO NOT MANUALLY UPDATE DO NOT SCALE		SCALE NONE
					CADFILE 02172
					SHEET 1 OF 1

REV.	DESCRIPTION OF CHANGES	APPROVED	DATE
2	ECRN 13948 - ADD "EP" & "EN" SERIES PART NUMBERS	AMS	01/19/06
1	ECRN 13842 - MODIFIED TABLE, ADDED NOTES	AMP	5/26/05

8

7

6

5

4

3

2

1