

THE INFORMATION CONTAINED IN THIS DRAWING IS THE SOLE PROPERTY OF ANDERSON POWER PRODUCTS. ANY REPRODUCTION IN PART OR WHOLE WITHOUT THE WRITTEN PERMISSION OF ANDERSON POWER PRODUCTS IS PROHIBITED.

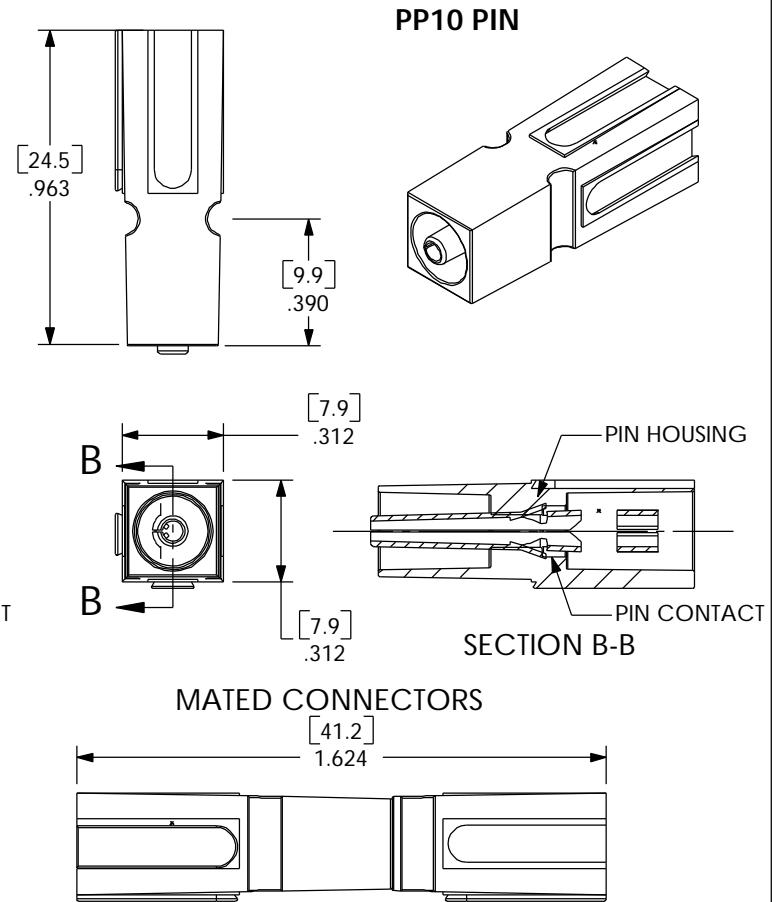
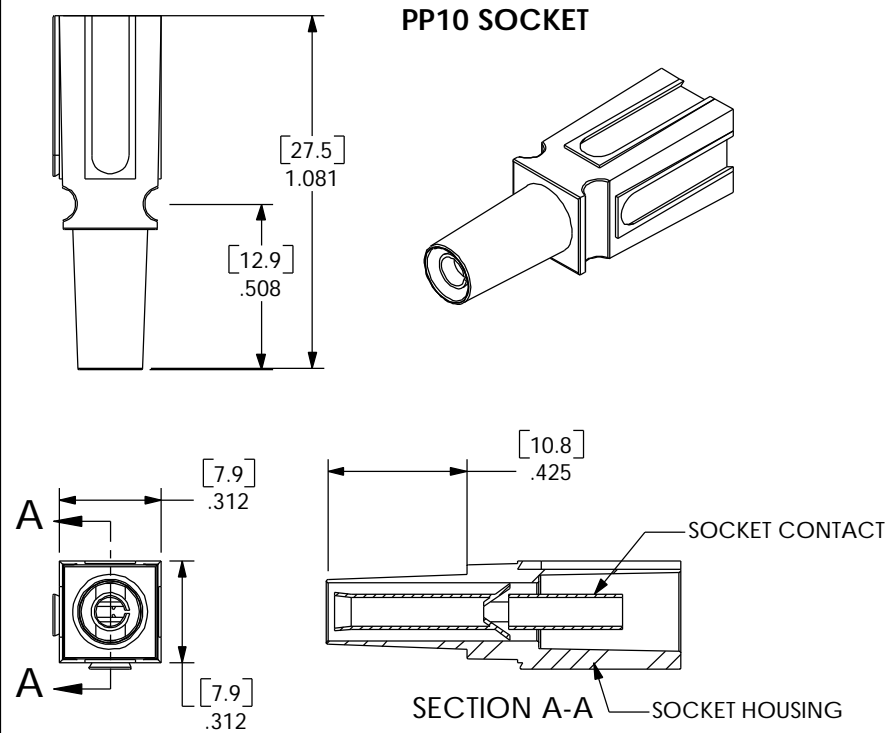

- NOTES:
- HOUSING AND CONTACT ASSEMBLIES ARE UL RECOGNIZED PER E2226 AND CSA CERTIFIED PER LR251 54.
  - MATERIAL:  
CONTACTS- BRASS- TIN PLATED  
HOUSINGS- POLYCARBONATE, UL94V0
  - CONTACTS ACCOMOATE 14/16 AWG WIRE

ITEM NO.	PART OR IDENTIFYING NO.	NOMENCLATURE OR DESCRIPTION	MATERIAL SPECIFICATION	QTY RECD	
PARTS LIST					
UNLESS OTHERWISE SPECIFIED:		CAD GENERATED DRAWING, DO NOT MANUALLY UPDATE	<b>ANDERSON POWER PRODUCTS</b>  <b>POWERPOLE 10 PIN AND SOCKET</b>		
DIMENSIONS ARE IN MM'S WITH INCHES IN [ ], TOLERANCES ARE: 1 PL ±.4 2 PL ±.02		APPROVALS			DATE
MATERIAL SEE NOTES		DRAWN CMS			1/25/99
FINISH --		CHECKED DJD			1/26/99
		RESP ENG		SIZE	
		MFG ENG		DWG. NO. <b>114199S1</b>	
		OC		REV. <b>0</b>	
				SCALE <b>2:1</b>	
				CAD FILE: 01128	
				SHEET 1 OF 1	

REV	DESCRIPTION	DATE	APP.