

THE INFORMATION CONTAINED IN THIS DRAWING IS THE SOLE PROPERTY OF ANDERSON POWER PRODUCTS. ANY REPRODUCTION IN PART OR WHOLE WITHOUT THE WRITTEN PERMISSION OF ANDERSON POWER PRODUCTS IS PROHIBITED.

BY:	DATE
CGC	4/23/98
DESCRIPTION OF CHANGES	
REV.	UPDATED TO CAD (ECRN 13058)
5	

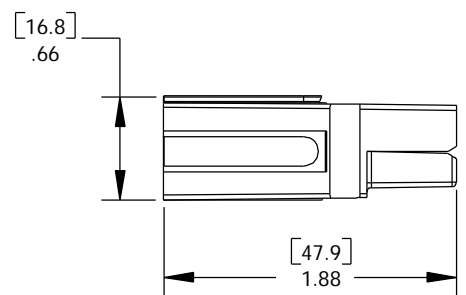
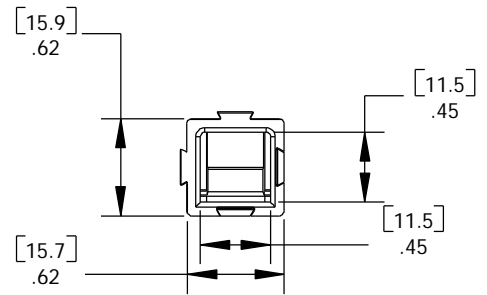
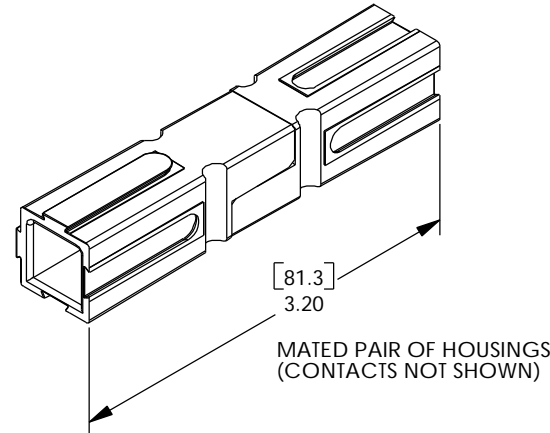
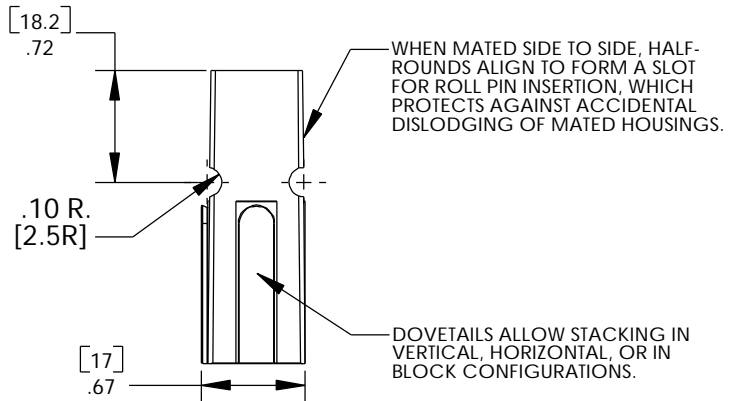

CAT. NO.	COLOR
5916	BLUE
5916G4	BLACK
5916G5	WHITE
5916G6	GREEN
5916G7	RED

NOTES:

1. SPRING/HOUSING ASSEMBLIES ARE UL RECOGNIZED PER FILE E26226 AND CSA CERTIFIED PER LR25154.
2. THESE HOUSING ASSEMBLIES ACCOMMODATE ANDERSON CONTACTS FOR WIRE RANGES FROM #12 AWG TO #6 AWG.
3. FOR ASSEMBLY INSTRUCTIONS, SEE DOCUMENT 1S1072.
4. HOUSINGS: POLYCARBONATE, UL94V0.
SPRING: STAINLESS STEEL.
FOR OTHER COLORS, CONSULT ANDERSON POWER PRODUCTS.

ITEM NO.	PART OR IDENTIFYING NO.	NOMENCLATURE OR DESCRIPTION	MATERIAL SPECIFICATION	QTY RECD
PARTS LIST				
DIMENSIONS ARE IN INCHES DIMENSIONS IN PARENTHESES [] ARE IN MILLIMETERS		CAD GENERATED DRAWING. DO NOT MANUALLY UPDATE		ANDERSON POWER PRODUCTS 5916-SERIES "POWERPOLE 75" HOUSING/SPRING ASSEMBLY UP TO 75 AMP APPLICATIONS
TOLERANCES ARE: 2 PLC. DECIMALS +/- .02 [+/- .5]		APPROVALS	DATE	
MATERIALS: <i>SEE NOTE 4.</i>		DRAWN M. MATANES	1/30/69	
NEXT ASSY		USED ON	FINISH	
APPLICATION		DO NOT SCALE DRAWING		SIZE A DWG. NO. 1-9597S7 SCALE - CAD FILE: 00832 SHEET 1 OF 1 REV. 5