

THE INFORMATION CONTAINED IN THIS DRAWING IS THE SOLE PROPERTY OF ANDERSON CARBOLON GROUP. ANY REPRODUCTION IN PART OR WHOLE WITHOUT THE WRITTEN PERMISSION OF ANDERSON CARBOLON GROUP IS PROHIBITED.

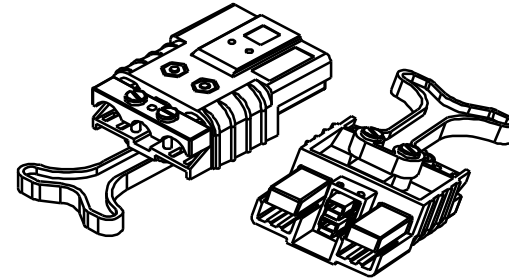
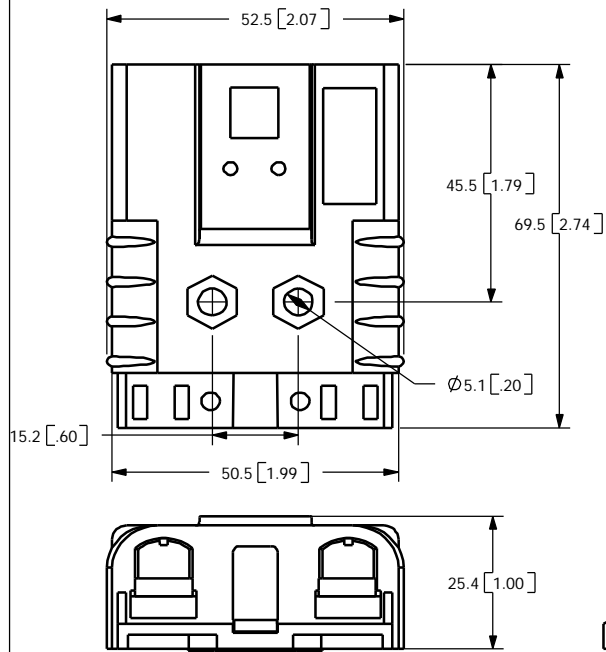

SBE 80 SHOWN WITH OPTIONAL CABLE CLAMP, HANDLE AND AUXILIARY POWERPOLE HOUSINGS

NOTES:

1. SPRING/HOUSING ASSEMBLIES ARE UL RECOGNIZED PER FILE E26226, CSA CERTIFIED PER LR25154, AND VDE CERTIFIED PER REGISTRY NO. 6302 UG.
2. HOUSINGS ARE KEYS TO ONLY ALLOW MATING WITH THE SAME COLOR HOUSING
3. FOR ASSEMBLY INSTRUCTIONS SEE DOCUMENT 156331
4. HOUSINGS ASSEMBLIES ACCOMODATE ANDERSON CONTACTS FOR WIRE SIZE #6 AWG OR 16MM ONLY.
5. MATERIAL:
HOUSINGS- PBT, UL94V0
SPRING- STAINLESS STEEL
6. OPTIONAL AUXILIARY POWERPOLE HOUSINGS AND CONTACTS AVAILABLE

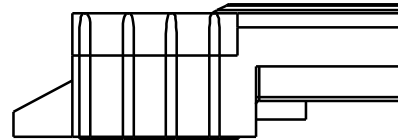

REV	DESCRIPTION	DATE	APP.

ITEM NO.	PART OR IDENTIFYING NO.	NOMENCLATURE OR DESCRIPTION	MATERIAL SPECIFICATION	QTY REQD
PARTS LIST				
UNLESS OTHERWISE SPECIFIED:		ANDERSON CARBOLON GROUP		
DIMENSIONS ARE IN MM'S WITH INCHES IN [], TOLERANCES ARE: 1 PL ±.4 2 PL ±.02		SBE 80 HOUSING AND SPRING OUTLINE DRAWING		
MATERIAL SEE NOTES		APPROVALS	DATE	SIZE
FINISH --		DRAWN CMS	3/16/99	A
DO NOT SCALE DRAWING		CHECKED DJD	3/17/99	DWG. NO. 114129S1
		RESP ENG		REV. 0
		MFG ENG		
		QC		
		SCALE	CAD FILE: 00999	SHEET 1 OF 1