

8 7 6 5 4 3 2 1

THE INFORMATION CONTAINED IN THIS DRAWING IS THE SOLE PROPERTY OF ANDERSON POWER PRODUCTS. ANY REPRODUCTION IN PART OR WHOLE WITHOUT THE WRITTEN PERMISSION OF ANDERSON POWER PRODUCTS IS PROHIBITED.

D
BY: DATE
C
REV. DESCRIPTION OF CHANGES

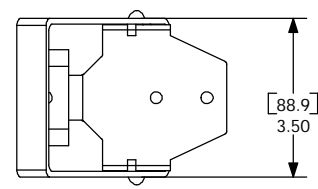

CLOSED POSITION

OPEN POSITION

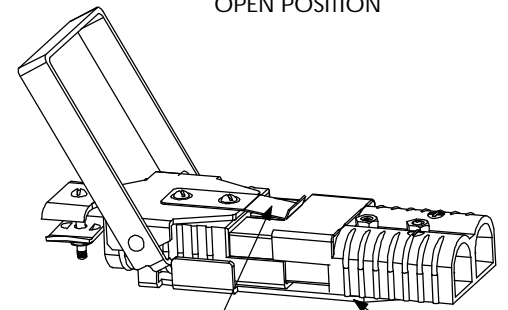
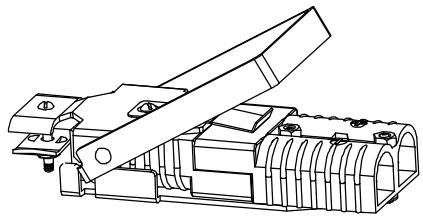

LOCK-OUT SPRING PREVENTS UNINTENTIONAL CONNECTION

MOUNTING HALF (TRUCK OR CHARGER)

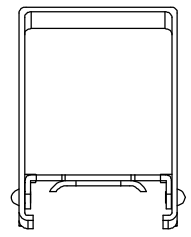

SHOULDER RIVET (2)

CABLE CLAMP

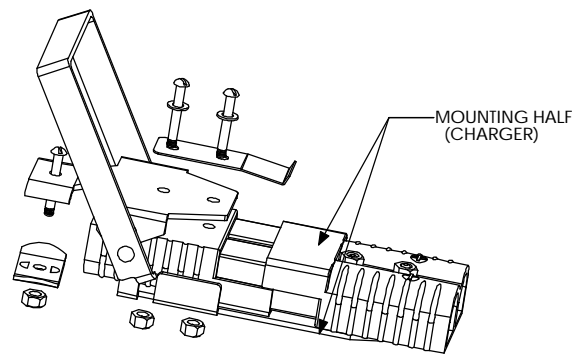

MOUNTING HALF (CHARGER)

COMPONENTS FOR SB350 MANUAL RELEASE LOCKING HALF WITH INTEGRAL CABLE CLAMP

COMPONENT	QTY
LOCKING HALF PLATE	1
HANDLE	1
LOCK-OUT SPRING	1
CABLE CLAMP	1
SCREWS	3
WASHERS	3
NUTS	3

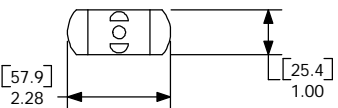

LOCK-OUT SPRING

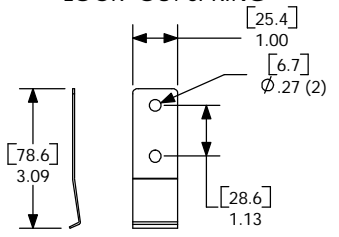

- NOTES
- MATERIALS:
PLATE AND HANDLE- #11 GA (.120") HOT ROLLED STEEL, PICKLED AND OILED
CABLE CLAMP- COLD ROLLED STEEL .083", #4 TEMPER
 - FINISH- ELECTROSTATIC POWDER COAT EPOXY- CRIMSON
 - USE WITH CATALOG NUMBER 922G1 (MOUNTING HALF)
 - CONNECTOR SOLD SEPARATELY

B

A

D

C

B

A

ITEM NO.	PART OR IDENTIFYING NO.	NOMENCLATURE OR DESCRIPTION	MATERIAL SPECIFICATION	QTY REQD
COPYRIGHT 1999 ANDERSON POWER PRODUCTS. ALL RIGHTS RESERVED. UNAUTHORIZED REPRODUCTION HEREBY PROHIBITED.				
DIMENSIONS ARE IN INCHES DIMENSIONS IN PARENTHESES [] ARE IN MILLIMETERS		CAD GENERATED DRAWING. DO NOT MANUALLY UPDATE		ANDERSON POWER PRODUCTS CATALOG NUMBER 919 SB350 MANUAL RELEASE LOCKING HALF HARDWARE WITH CABLE CLAMP
TOLERANCES ARE: 2PL- ±.02 [±.5]		APPROVALS	DATE	
MATERIALS: SEE NOTES		DRAWN	CMS 10/15/99	
FINISH: SEE NOTES		CHECKED	DJD 10/27/99	
NEXT ASSY USED ON		RESP ENG	UFN 10/28/99	SIZE A SPECIFICATION: 114200S2
APPLICATION		MFG ENG	CHB 11/1/99	REV. 0
DO NOT SCALE DRAWING		QUAL ENG	RPO 11/1/99	SCALE NONE
			CADFILES/01130	SHEET 1 OF 1

8 7 6 5 4 3 2 1

8 7 6 5 4 3 2 1

THE INFORMATION CONTAINED IN THIS DRAWING IS THE SOLE PROPERTY OF ANDERSON POWER PRODUCTS. ANY REPRODUCTION IN PART OR WHOLE WITHOUT THE WRITTEN PERMISSION OF ANDERSON POWER PRODUCTS IS PROHIBITED.

D
BY: _____
DATE _____
C
REV. _____
DESCRIPTION OF CHANGES

LOCKING HALF PLATE W/O CLAMP

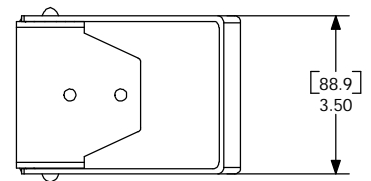

CLOSED POSITION

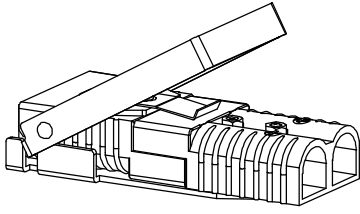

OPEN POSITION

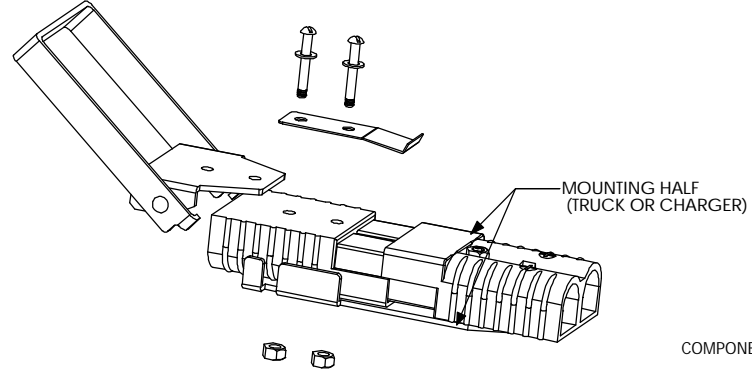
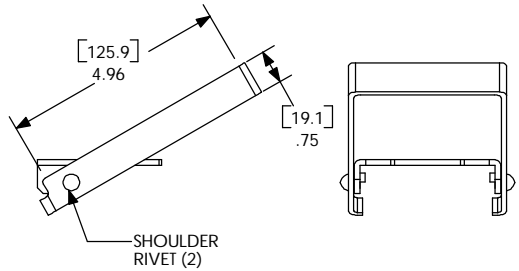
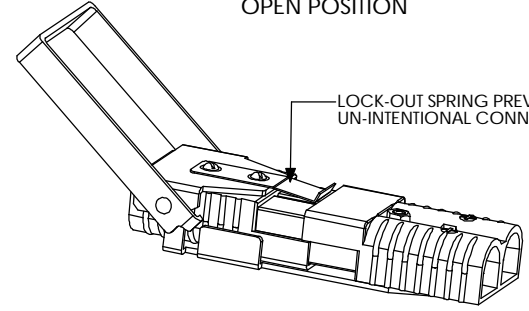

LOCK-OUT SPRING

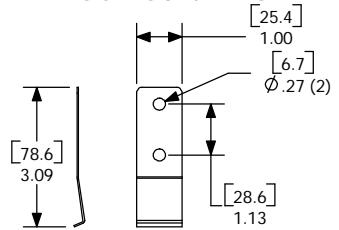

COMPONENTS FOR SB350 MANUAL RELEASE LOCKING HALF

COMPONENT	QTY
LOCKING HALF PLATE	1
HANDLE	1
LOCK-OUT SPRING	1
SCREWS	2
WASHERS	2
NUTS	2

- NOTES:
- MATERIALS:
PLATE AND HANDLE- #11 GA (.120") HOT ROLLED STEEL, PICKLED AND OILED. FINISH WITH ELECTROSTATIC POWDER COAT EPOXY-CRIMSON
LOCK-OUT SPRING- .035 THK 1075 CARBON STEEL
 - USE WITH CATALOG NUMBER 922G1 (MOUNTING HALF)

ITEM NO.	PART OR IDENTIFYING NO.	NOMENCLATURE OR DESCRIPTION	MATERIAL SPECIFICATION	QTY RECD	
COPYRIGHT 1999 ANDERSON POWER PRODUCTS. ALL RIGHTS RESERVED. UNAUTHORIZED REPRODUCTION HEREBY PROHIBITED.					
DIMENSIONS ARE IN INCHES DIMENSIONS IN PARENTHESES [] ARE IN MILLIMETERS		CAD GENERATED DRAWING. DO NOT MANUALLY UPDATE	ANDERSON POWER PRODUCTS		
TOLERANCES ARE: 2PL- ±.02 [±.5]		APPROVALS			DATE
MATERIALS: SEE NOTES		DRAWN			DATE
FINISH SEE NOTES		CHECKED			DATE
NEXT ASSY	USED ON	RESP ENG	DATE		
APPLICATION	DO NOT SCALE DRAWING	MFG ENG	DATE		
		QUAL ENG	DATE		
			SIZE A	SPECIFICATION: 114200S3	
			SCALE NONE	REV. 0	
			CADFILES/01131	SHEET 1 OF 1	

8 7 6 5 4 3 2 1

8 7 6 5 4 3 2 1

THE INFORMATION CONTAINED IN THIS DRAWING IS THE SOLE PROPERTY OF ANDERSON POWER PRODUCTS. ANY REPRODUCTION IN PART OR WHOLE WITHOUT THE WRITTEN PERMISSION OF ANDERSON POWER PRODUCTS IS PROHIBITED.

DATE	
BY:	
DESCRIPTION OF CHANGES	
REV.	

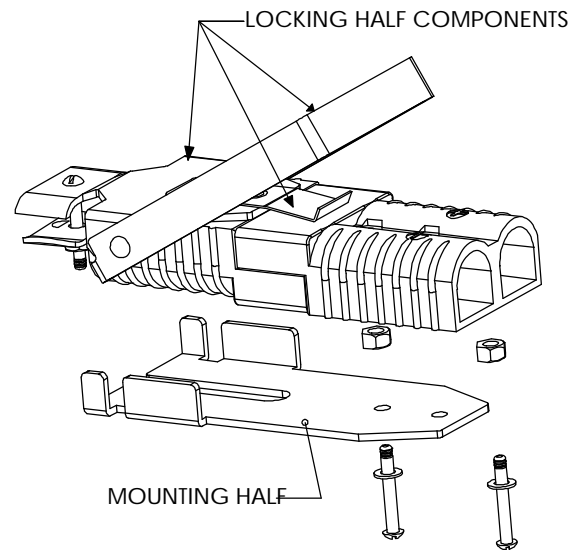
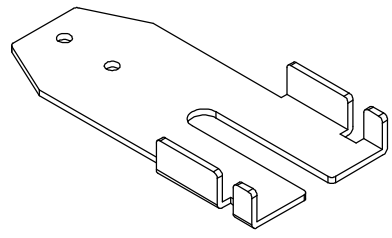
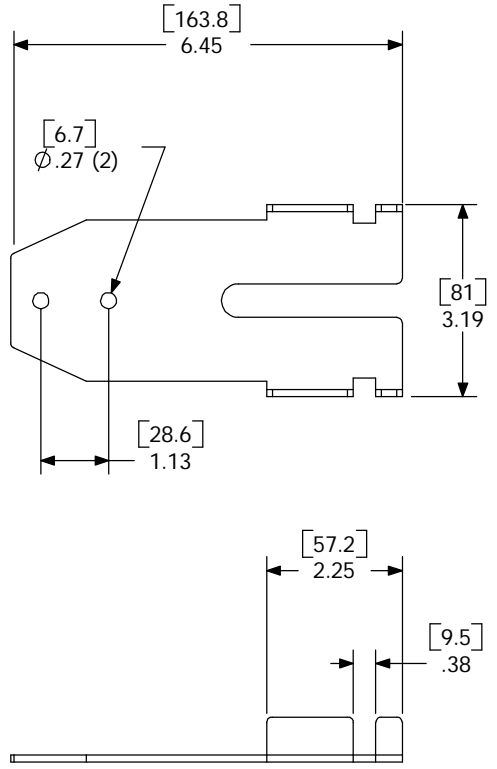

COMPONENTS FOR MOUNTING HALF-SB350 MANUAL RELEASE

COMPONENT	QTY
MOUNTING HALF	1
SCREWS	2
WASHERS	2
NUTS	2

- NOTES:
- MATERIAL
#11 GA (.120) HOT ROLLED STEEL PICKLED AND OILED
ELECTROSTATIC POWDER COAT EPOXY- CRIMSON RED
 - USE WITH EITHER CATALOG NUMBER 919 (LOCKING HALF W/ CLAMP)
OR 919G1 (LOCKING HALF WITHOUT CLAMP)

NEXT ASSY	USED ON
APPLICATION	DO NOT SCALE DRAWING

ITEM NO.	PART OR IDENTIFYING NO.	NOMENCLATURE OR DESCRIPTION	MATERIAL SPECIFICATION	QTY RECD	
COPYRIGHT 1999 ANDERSON POWER PRODUCTS. ALL RIGHTS RESERVED. UNAUTHORIZED REPRODUCTION HEREBY PROHIBITED.					
DIMENSIONS ARE IN INCHES DIMENSIONS IN PARENTHESES [] ARE IN MILLIMETERS		CAD GENERATED DRAWING. DO NOT MANUALLY UPDATE	ANDERSON POWER PRODUCTS CATALOG #922G1 SB350 MANUAL RELEASE MOUNTING HALF HARDWARE FOR TRUCK OR CHARGER		
TOLERANCES ARE: 2PL- ±.02 [±.5]		APPROVALS			DATE
MATERIALS: SEE NOTES		DRAWN			CMS 10/15/99
FINISH SEE NOTES		CHECKED			DJD 10/27/99
MFG ENG		RESP ENG	UFN 10/28/99	SIZE A	
QUAL ENG		RPO 11/1/99	SPECIFICATION:	114200S1	
SCALE		NONE	CADFILES/01129	REV. 0	
SHEET		1 OF 1			

8 7 6 5 4 3 2 1